



PETROLEUM 120

2" x 1-1/2" End Suction Centrifugal Pump

The Petroleum 120 End Suction Centrifugal Pump is engineered for superior performance in transferring petroleum-based liquids.

This series includes three models – SO 120, SG 120, and SE 120 – each designed to accommodate different operational requirements. Built for compatibility with 184TC frame electric motors, these pumps support multiple mounting configurations such as pedestal setups and PumpAKs®, ensuring easy integration into diverse systems.

Known for its durability and efficiency, the Petroleum 120 series offers flexible installation with pump rotation adjustable in 90° increments. Whether the application involves ethanol, gasoline, biodiesel, or other petroleum-derived fluids, these pumps deliver consistent and reliable fluid handling.

The Petroleum 120 Pump is available in three distinct models: SE, SG and SO:

Model SE Pumps - Compatible For Ethanol & E 85

Model SG Pumps - Compatible For Gasoline, Kerosene, Avgas & Jet Fuel

Model SO Pumps - Compatible For BioDiesel, Fuel Oil & Diesel

SPECIFICATIONS:

Suction / Discharge	2" x 1-1/2" 150# flange
Flow	Up to 200 GPM (45.4 m³/h)
Head Feet	Up to 135' (41 m)
Impeller	SE 120 - semi open cast iron SG 120 - semi open aluminum SO 120 - semi open cast iron
Motor	Up to 7 1/2 (5.5 kW)
Drive Options	Close coupled 184TC Pedestal PumpAK® (without motor)
Seal	SE 120 - carbon / silicon carbide / viton SG 120 - carbon / silicon carbide / viton SO 120 - carbon / ni-resist / viton
Mounting Options	SE 120 - Explosion proof Class 1 Group D SG 120 - Explosion proof Class 1 Group D SO 120 - TEFC
Compatible For	SE 120 - Ethanol, E 85 SG 120 - Gasoline, Avgas, Kerosene, Jet A/8 SO 120 - Biodiesel, Fuel Oil, Diesel

Features

- Non-spark clamp

Application:

- Agricultural
- Industrial
- Marine
- OEM

PERFORMANCE CURVES

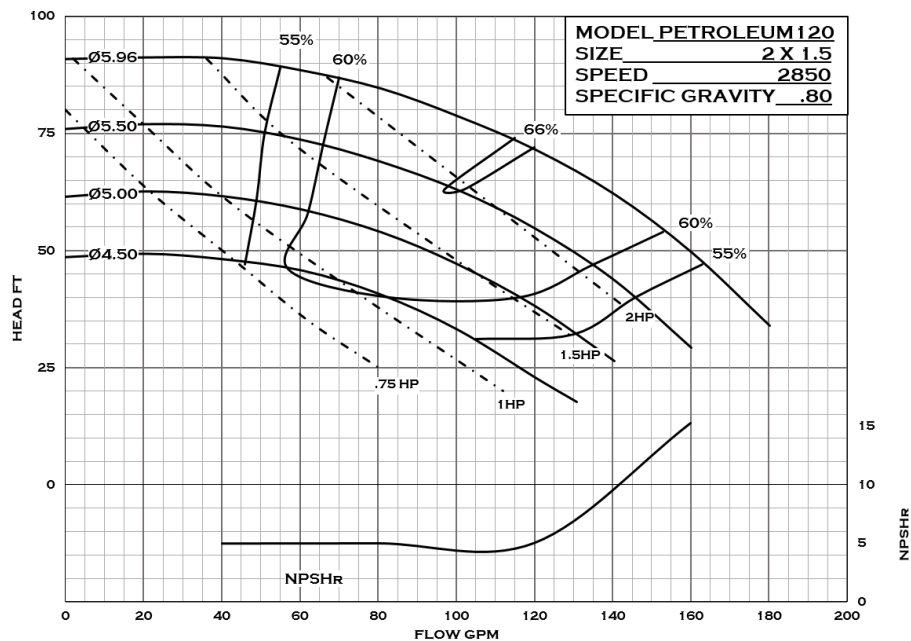
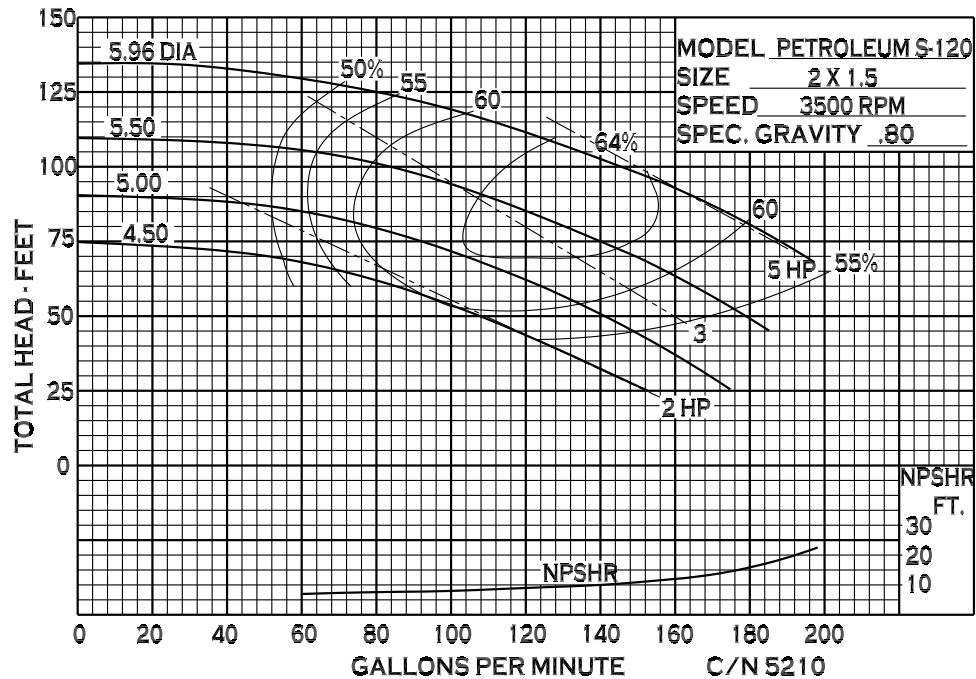

DIMENSIONS

CLOSE COUPLED - ELECTRIC MOTOR

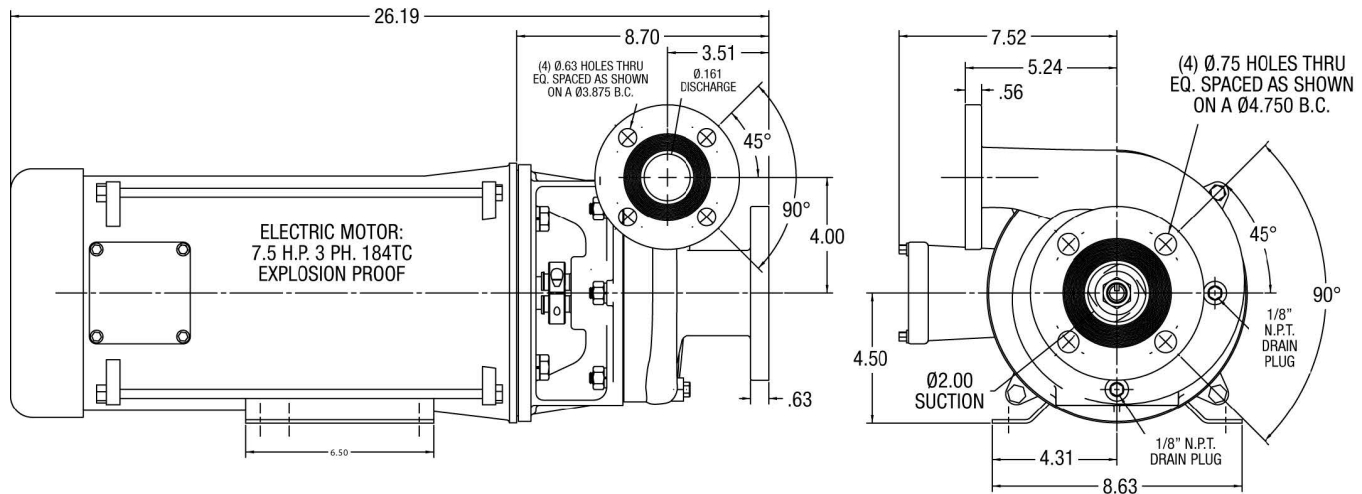

PEDESTAL - MOUNT

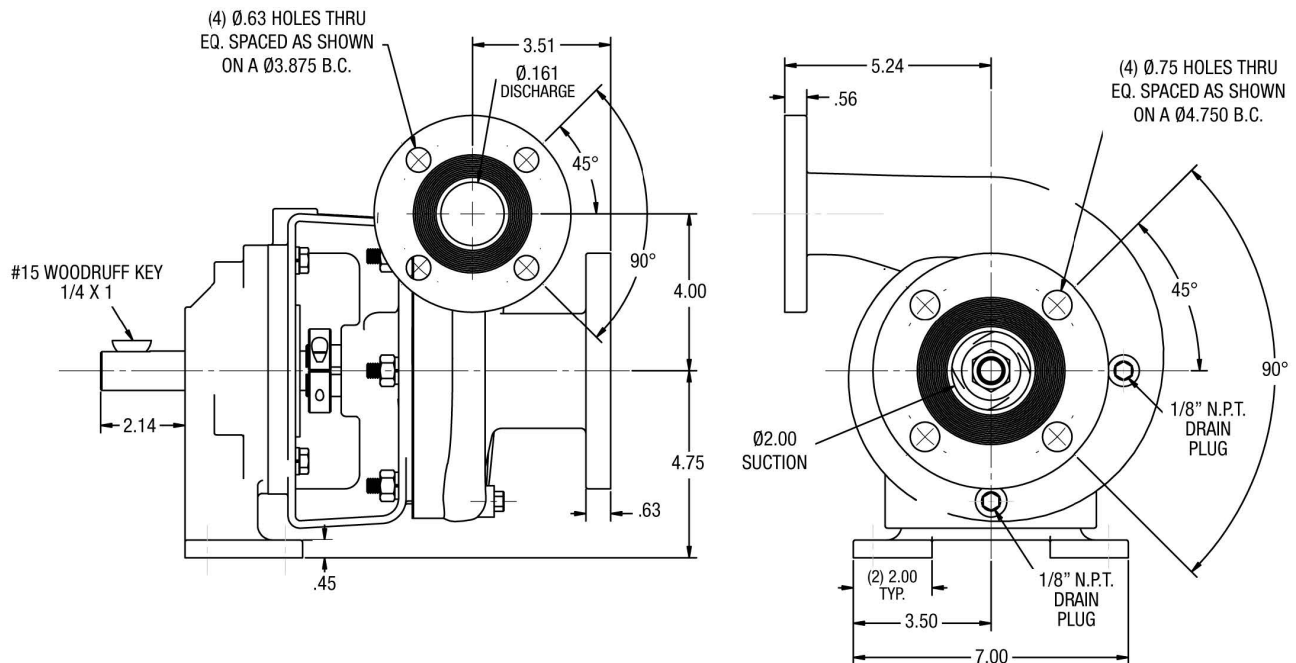

* For complete parts lists and troubleshooting guidance, please refer to the MP Pumps Installation Operation & Maintenance (IOM) Manual.